

Pressure Reducing Valve

200X-10Q/16Q

Chuanli 200X-10Q/16Q pressure reducing valve consists of a main valve, pilot valve, needle valve, ball valve, and pressure gauge valve. The needle valve, ball valve, and pressure gauge are composed of a hydraulic control receiver system. The structure form is a T-type diaphragm drive.

Performance Parameter

Nominal Pressure: 1.0/1.6Mpa
 Applicable Temperature: 0 - 80°C
 Applicable Medium: Water, Water with mud
 and sand

Main Components

Valve body: Cast iron
 Valve bonnet: Cast iron
 Valve stem: Stainless steel

FEATURES

- It can balance and regulate the pressure of network water supply pipeline, energy saving and consumption reduction.
- Using its own pipeline pressure to regulate and control the pressure after the valve, reducing and stabilizing pressure reliably.
- The outlet pressure after the valve does not change with the change of inlet pressure and flow rate, and it can automatically maintain the outlet pressure on the adjusted stop.
- The valve control sensitivity is high, safe and reliable, easy to debug, long service life.
- The valve should be equipped with a filter, and an exhaust valve should be installed at the high point of the pipe section after the valve.
- Suitable for life, fire, high-rise buildings and other water supply network systems and urban water supply projects and other industrial water supply systems.

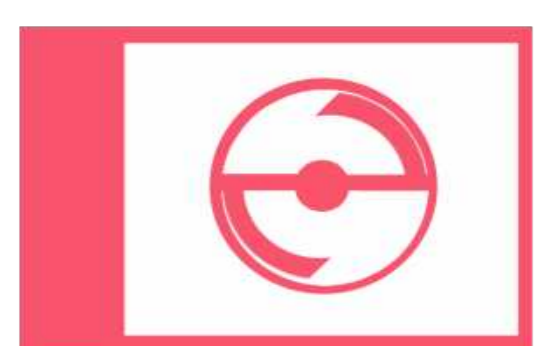

The design, materials and specifications are subject to change without notice. This is due to continuous development

Main Components

Main Components	
Valve body:	Cast iron
Valve bonnet:	Cast iron
Valve stem:	Stainless steel
Spring:	Stainless steel
Seals:	NBR/EPDM

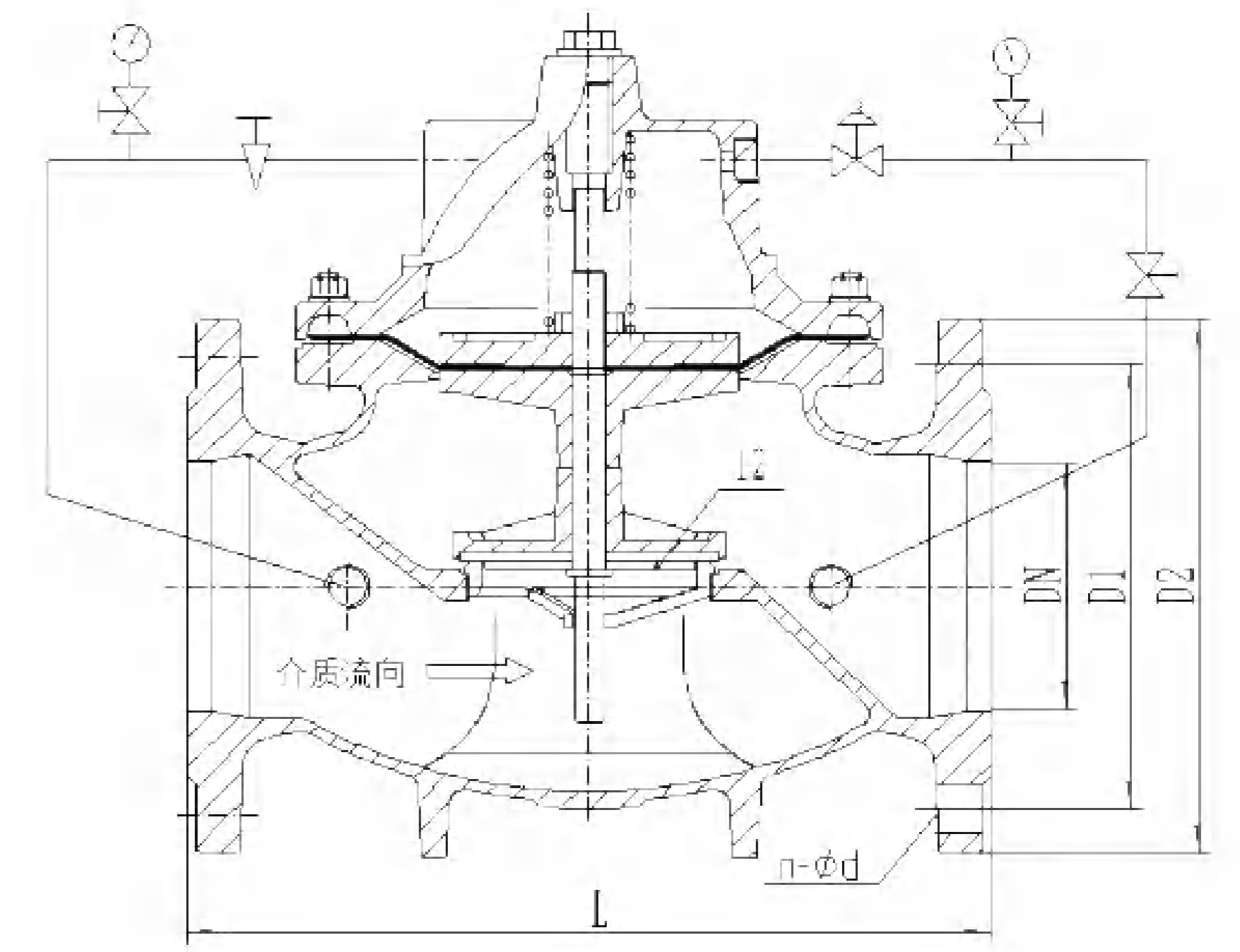

Installation Dimension Unit : mm

DN	L	H	1.0 MPa			1.6 MPa		
			D	D1	n - φd	D	D1	n - φd
50	240	278	160	125	4-φ19	160	125	4-φ19
65	240	298	180	145	4-φ19	180	145	4-φ19
80	292	313	200	160	8-φ19	200	160	8-φ19
100	325	350	220	180	8-φ19	220	180	8-φ19
125	340	365	250	210	8-φ19	250	210	8-φ19
150	403	420	285	240	8-φ23	285	240	8-φ23
200	435	450	340	295	8-φ23	340	295	12-φ23
250	510	470	395	350	12-φ23	405	355	12-φ28
300	600	490	445	400	12-φ23	460	410	12-φ28
350	670	526	505	460	16-φ23	520	470	16-φ28
400	730	570	565	515	16-φ28	580	525	16-φ31
450	730	610	615	565	20-φ28	640	585	20-φ31
500	780	665	670	620	20-φ28	715	650	20-φ34
600	970	725	780	725	20-φ31	840	770	20-φ37
700	1120	865	895	840	24-φ31	910	840	24-φ37
800	1750	975	1015	950	24-φ34	1025	950	24-φ40

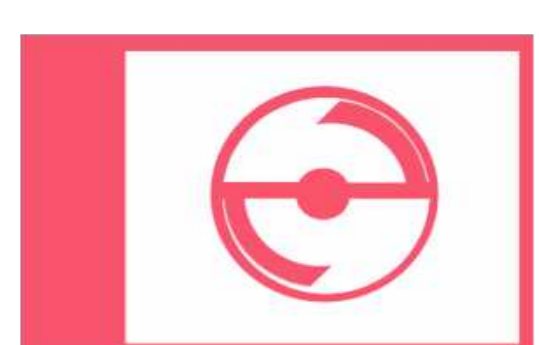

The design, materials and specifications are subject to change without notice. This is due to continuous development