

Double flange loose set limit joint

C2F-10Q/16Q

The compensation joint comprises a body, a telescopic tube, and a gland. This force transfer joint is rigidly connected and can transmit axial force once all nuts are tightened.

Performance Parameter

Nominal Pressure: 1.0/1.6MPa
 Applicable Temperature: 0~80° C
 Applicable Medium: Muddy water, fresh water, oil

Main Components

Part Name: Material
 Valve jackets, expansion tubes, pressure plates:
 Nodular cast iron/carbon steel
 Seals: NBR/EPDM
 Limit screw: Carbon Steel Galvanized

FEATURES

- Both the inner and outer jacket are free to expand and contract at both ends.
- Convenient for installation of valves and fittings, saving installation time and cost.
- Eliminate the deformation pressure of the pipeline, preventing the pipeline from deformation to produce broken rings.
- Compensate the axial, lateral and angular deformation of the pipeline caused by temperature difference, pressure and installation connection.
- Eliminate the influence of earthquake and ground subsidence on the
- Excellent sealing performance, bi-directional zero leakage.
- Limit tie rod device to prevent the inner and outer jacket from pulling off.
- Adopting sealing rubber ring sealing, good sealing effect and small expansion resistance.

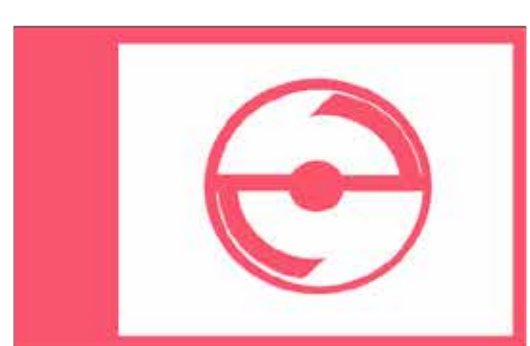

The design, materials and specifications are subject to change without notice. This is due to continuous development

Main Components

Main Components	
Part Name:	Material
Valve jackets, expansion tubes, pressure plates:	Nodular cast iron/carbon steel
Seals:	NBR/EPDM
Limit screw:	Carbon Steel Galvanized

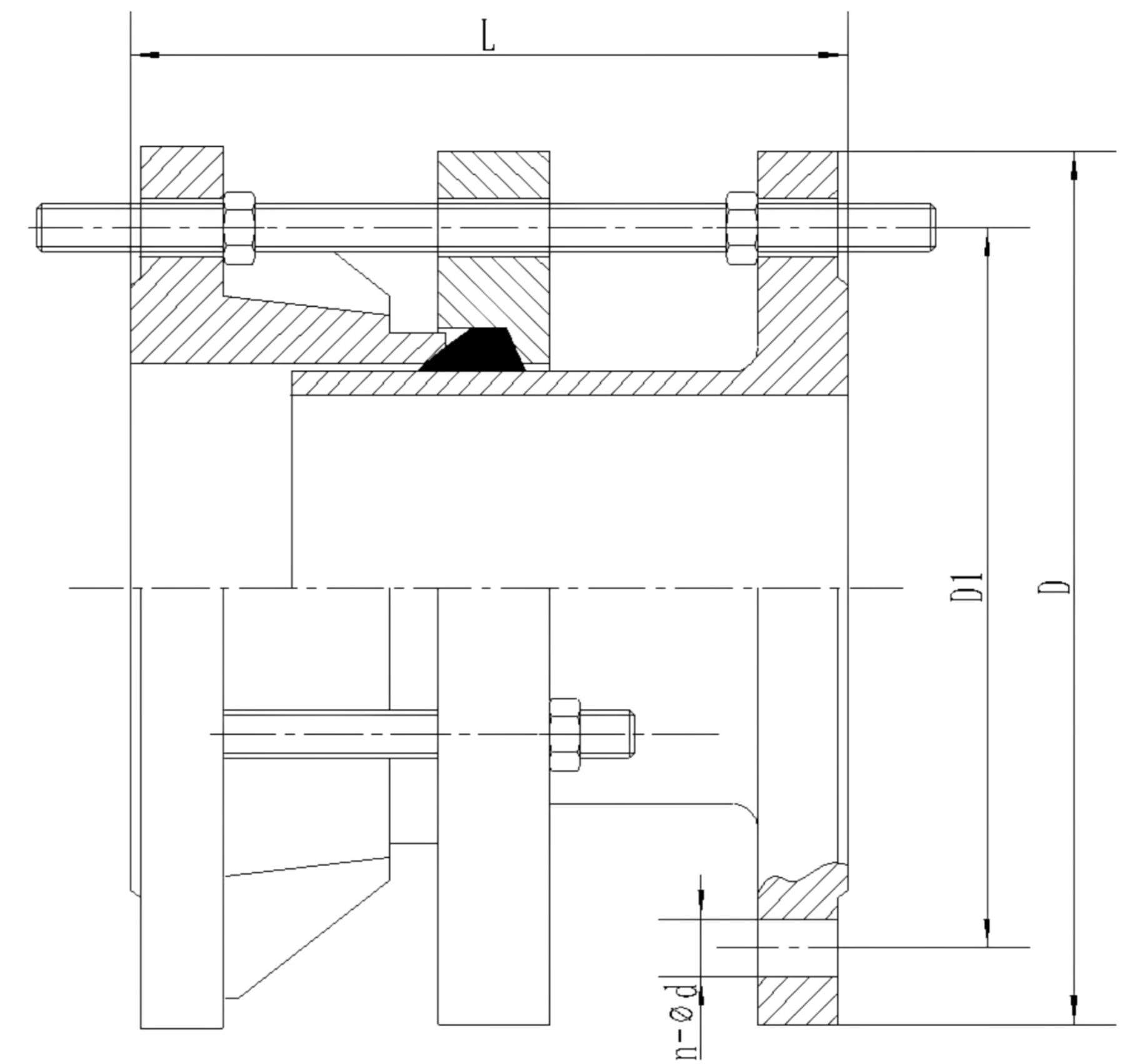

Installation Dimension Unit : mm

DN	L	1.0MPa			1.6MPa		
		D	D1	n - φd	D	D1	n - φd
50	/	165	125	4 - φ19	165	125	4 - φ19
65	200±20	185	145	4 - φ19	185	145	4 - φ19
80	200±20	200	150	8 - φ19	200	160	8 - φ19
100	200±20	220	180	8 - φ19	220	180	8 - φ19
125	200±20	250	210	8 - φ19	250	210	8 - φ19
150	200±20	235	240	8 - φ23	285	240	8 - φ23
200	200±20	340	295	8 - φ23	340	295	12 - φ23
250	200±20	395	350	12 - φ23	405	355	12 - φ28
300	220±25	445	400	12 - φ23	460	410	12 - φ28
350	220±25	505	460	16 - φ23	520	470	16 - φ28
400	220±25	565	515	16 - φ23	580	525	16 - φ31
450	220±25	615	565	20 - φ28	640	585	20 - φ31
500	220±25	670	620	20 - φ28	715	650	20 - φ34
600	240±25	780	725	20 - φ31	840	770	20 - φ37
700	240±25	895	840	24 - φ31	910	840	24 - φ37
800	350±30	1015	950	24 - φ34	1025	950	24 - φ40
900	350±30	1115	1050	28 - φ34	1125	1050	28 - φ40
1000	350±30	1230	1160	28 - φ37	1255	1170	28 - φ43
1200	370±30	1455	1380	32 - φ40	1485	1390	32 - φ49

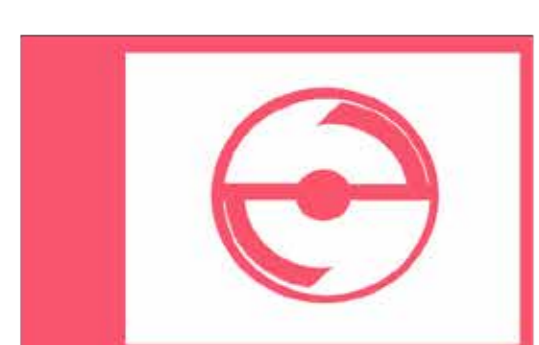

The design, materials and specifications are subject to change without notice. This is due to continuous development